



## PRESS RELEASE

**Press Contact:** François Libner, CEO Libner group – Mobile: +33 6 0710 4782  
Joël Perret, Site Manager – Mobile: +33 6 7703 0777

**PALKIT** is one of the world's leading manufacturers of light, medium and heavy-duty truck and van body KITS located in France.

**PALKIT** designs, manufactures and markets a complete range of truck and van bodies to accommodate cargo of every configuration of commercial vehicles from 3,5 T to trailers, semitrailers or swap bodies.

**PALKIT** is the leader in custom built bodies meeting any demands your business may require. From dry freight delivery to construction site boxes as well as work-shops boxes, we have a solution to suit your industry and keep your business moving ahead.

The kit structures are made of aluminium extrusion profiles and our production is split in different product families :

- Smooth aluminium kits consisting of aluminium panels of 583 or 375 mm wide assembled with clamped aluminium profiles,
- Fibreglass Reinforced Plywood (FRP) panel kits,
- Lightweight panel kits : polyester skin reinforced with vertical aluminium uprights, lightweight panel with a high density PET foam core,
- Insulated panel kits using a polyurethane foam core,
- Curtain side bodies,
- Sub-frame either in aluminium or galvanised steel





## COMPANIES WHICH ARE PART OF THE LIBNER GROUP :

### LIBNER - Saint-Maixent l'Ecole (79400) – France :

Production site specialized in the design and manufacturing of a complete range of bodies and body kits for light and heavy duty trucks from 3,5 T to 44 T.

### Bâche Jean - Saint- Maixent l'Ecole (79400) – France :

Production site specialized in manufacturing tarpaulin and curtains for both transport and leisure industries.

### Palkit - Vonnas (01540) – France :

Production site specialized in the design and manufacturing of a complete range of light, medium and heavy-duty truck and van body KITS suitable for commercial vehicle from 3,5 T to semitrailers.

### Libner Polska - Kutno – Poland :

Production site specialized in subcontracting for laser cutting, folding and welding, Libner Polska also assembles bodies for the Eastern European market.

## PRODUCTS DISPLAYED ON OUR BOOTH :

### **Dry box fitted to an electric vehicle : “Urban freight distribution”**

---

Dry box mounted on a new GOUPIL-G6 vehicle chassis (GVWR 2,5 tonnes)

Built as a test product for marker research, we have used 14 mm FRP panels, a rear frame with 2 barn doors and 1 external sliding door on the right-hand side – unlocking from the inside.

This product will be available next year 2020

### **BeeBOX : “Dry box for light-duty truck”**

---

Sides and bulkhead can be constructed with 14 mm thick Fibreglass Reinforced Plywood panels or durable 17 mm gel coated (polyethylene terephthalate) with a high density PET foam core.

This dry box supplied with the sub-frame (aluminium longitudes and galvanised steel or aluminium cross-members) is available on cargo or courier applications.

This lightweight construction is a significant advantage in respect of payload to meet the new test called the Worldwide Harmonised Light Vehicle Test Procedure (WLTP).

### **Aluminium sub-frame :**

**BODY RANGE 6,5 T max.**

---

Mechanical assembly – bolted sub-frame, no welding,

Decking supported by aluminium longitudes and ALUMINIUM or GALVANISED STEEL cross-members for a quick assembly. This product is available for all lightweight vehicle chassis.

Optional extras : floors panels, one piece floor panel with non-slip structure on the inside, mudguards, side-guards, lighting kit, pull-out step for easier access and convenience

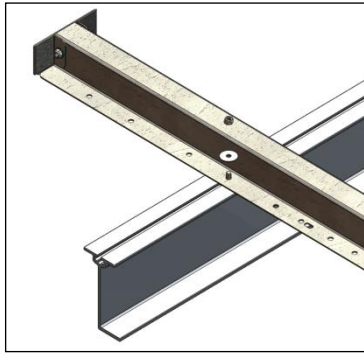

Galvanised steel cross-member

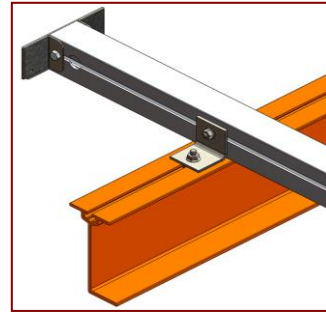

Aluminium cross-member

**EUROPAL & CLASSIC : “European Standard EN 12642 XL”**  
**You have asked for it, we got it ! »**

PALKIT designs, manufactures and markets a complete range of products in accordance with the EN 12642 XL European standards on the securing of cargo on road vehicles. Both of our executions EUROPAL & CLASSIC have successfully obtained the certification for all types of vehicles up to 19 t and 26t on some versions.